

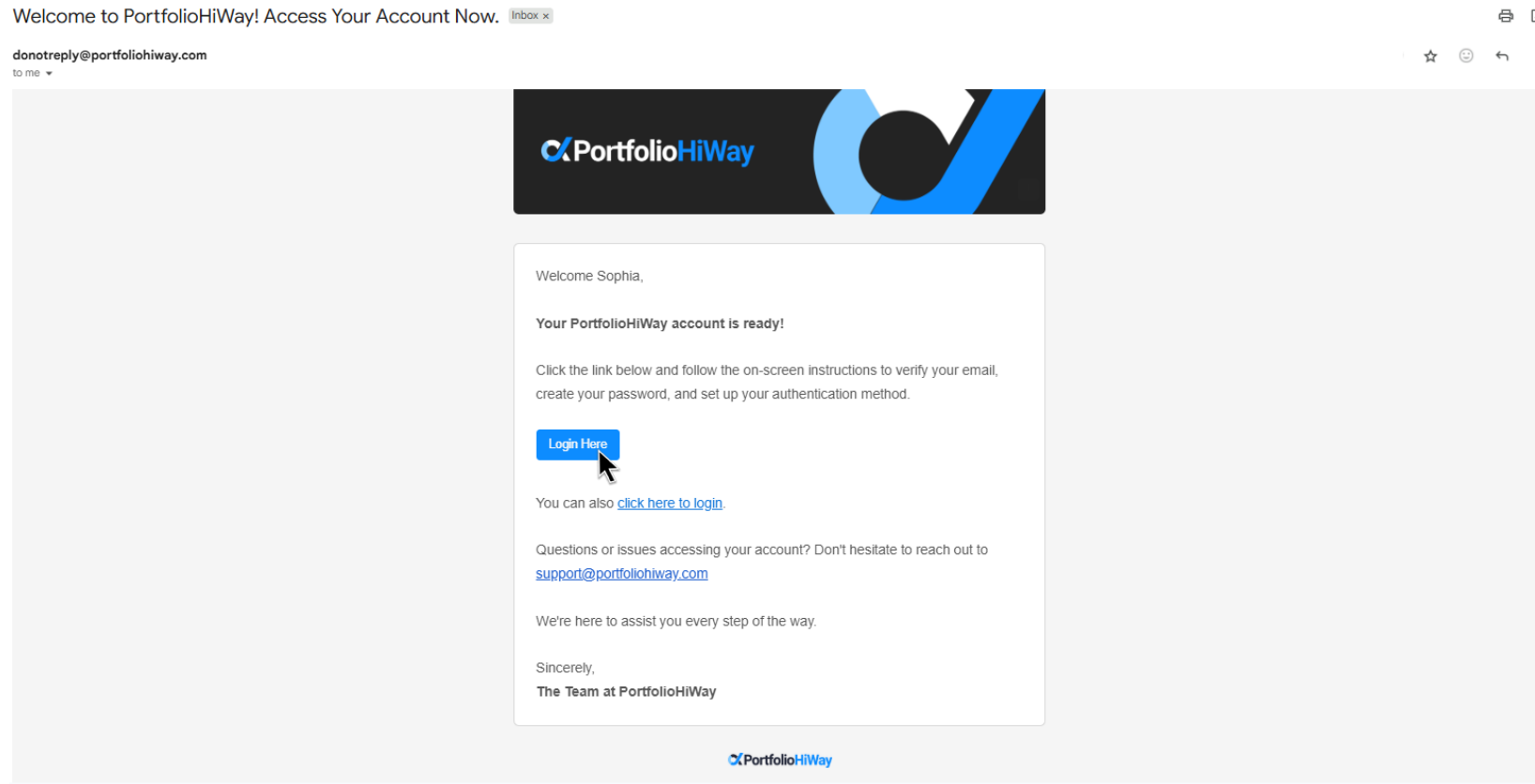

Getting Started



Start by opening your email account and select the email from donotreply@portfoliohiway.com titled “Welcome to Portfolio HiWay”. Click “Login Here”.



A new tab will open in your web browser. Enter your email address and click “Send verification code”.



A 6-digit verification code has now been sent to your email, titled “[PortfolioHiWay: Email Verification Code](#)”. Open the email and retrieve the code.

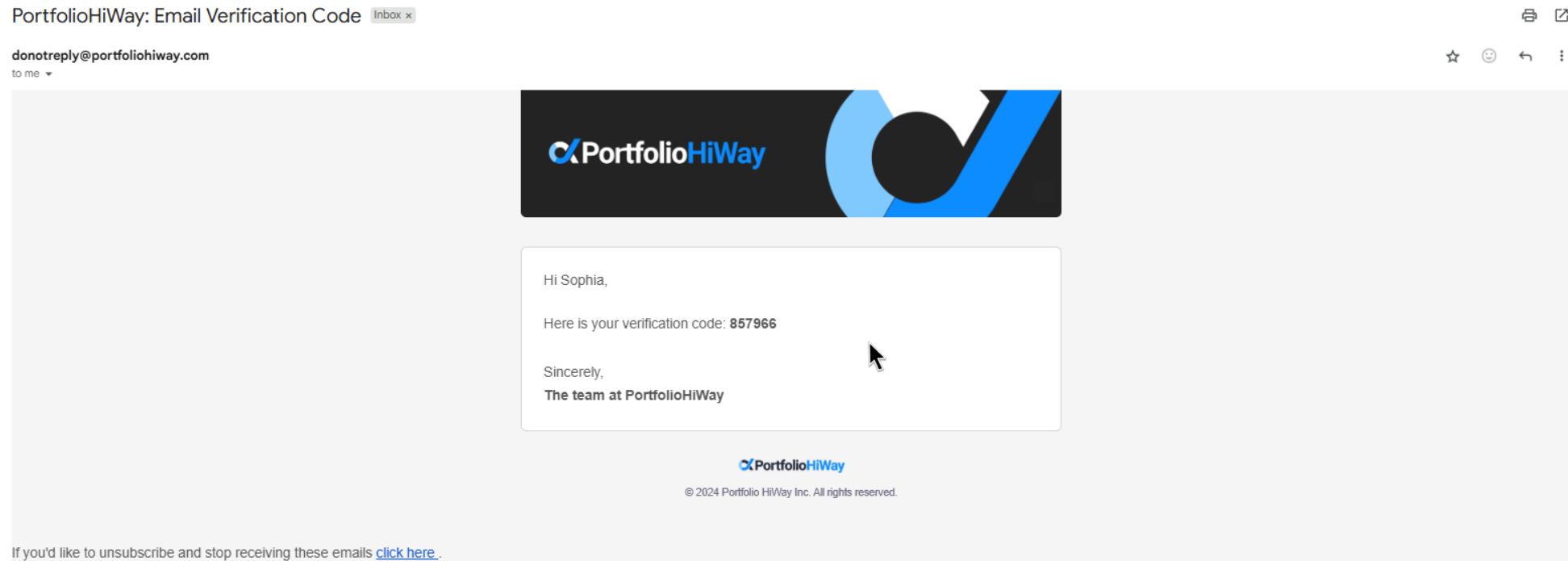

Enter the 6-digit verification code and click “Verify code”.



Welcome to PHW
Please enter the verification code sent to your email.

Verification code

[Verify code](#)

[Send new code](#)

[Cancel](#)

PortfolioHiWay

Your Partner on the Road to Alpha

Helping you confidently reach your destination

Once verified, click “Continue”.



Create a password that satisfies the password criteria, then press “Continue”.



Welcome to PHW
Create a 10-24 character password using at least one special character and one number.

New Password*

Strength: Strong

- ✓ Password must be 10-24 characters
- ✓ Include a lowercase letter
- ✓ Include an uppercase letter
- ✓ Include a number
- ✓ Include a symbol

Confirm New Password*

Continue

Cancel

PortfolioHiWay

Your Partner on the Road to Alpha

Helping you confidently reach your destination

Next, enable 2-Factor Authentication (“2FA”). You’ll first need your mobile device.

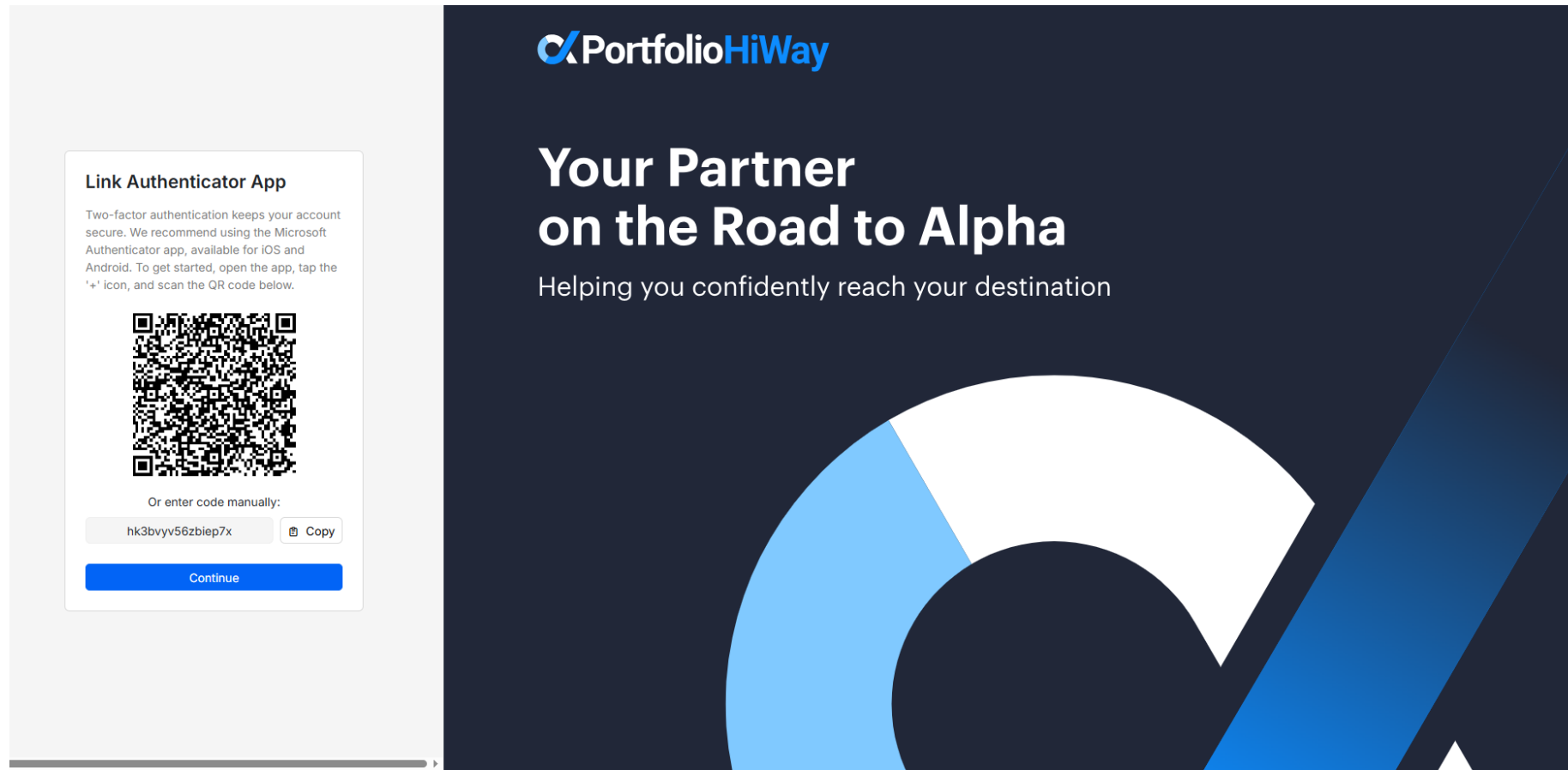

From your mobile device, open your app store and download your preferred authenticator app. Microsoft Authenticator is recommended.

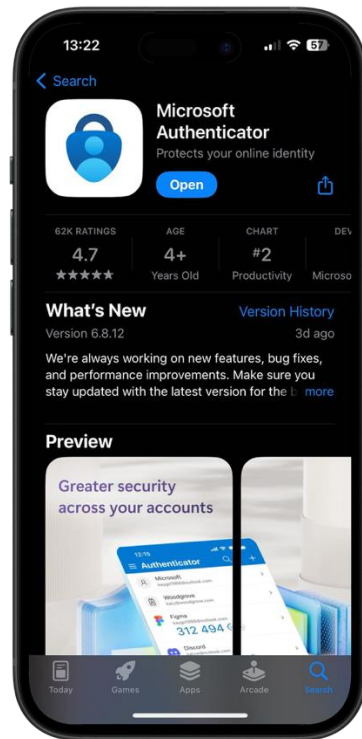

Apple App Store

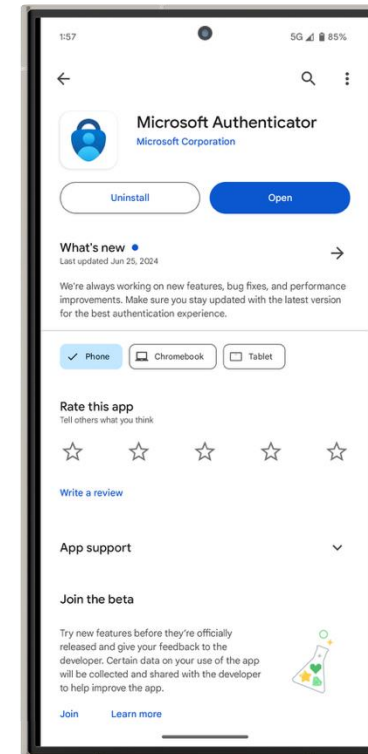

Samsung App Store

Once downloaded, open your authenticator app. Accept the privacy terms and click “Scan a QR code”.

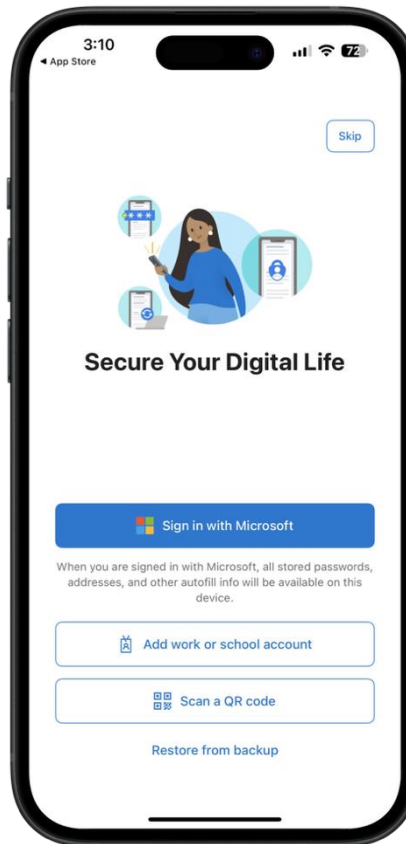

If you already have an authenticator app downloaded to your mobile device, proceed with opening it up and tap “+”, “Add”, “Add account” or similar text . Then click “Scan QR code”.

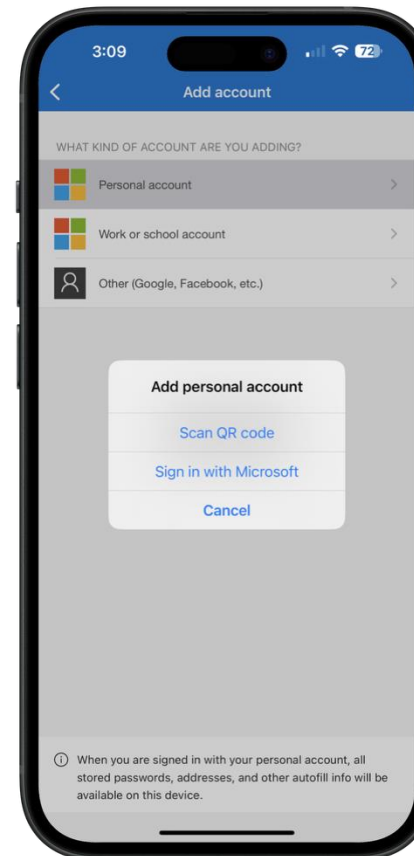
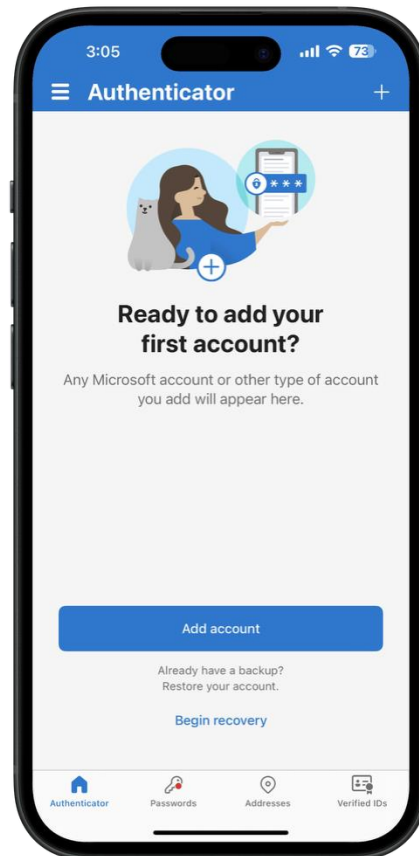

Your authenticator app will turn on your mobile device camera. Point the camera at the QR code on your computer screen to scan.

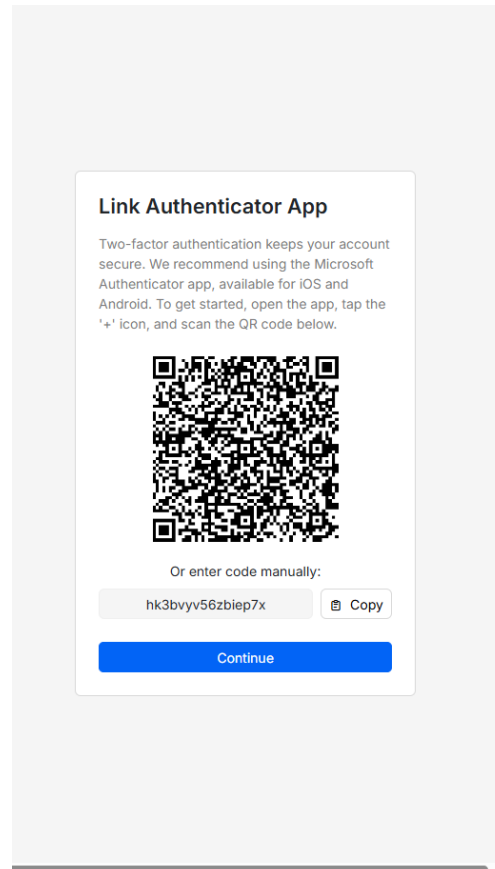

Once the QR code has been scanned, your authenticator app will automatically create an authentication profile, linked to your client portal. Next, click “Continue”.

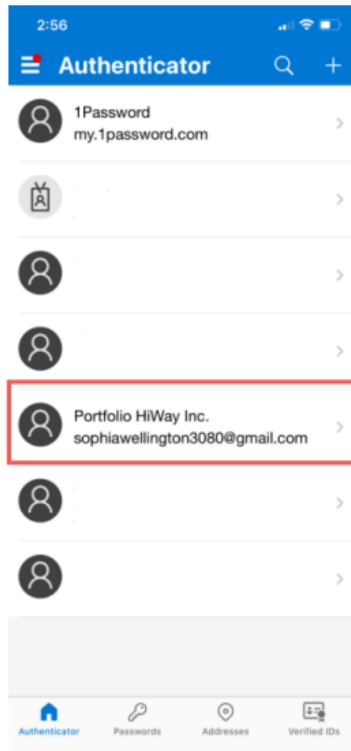

Using the 6-digit verification code, click “Verify”. Your 2FA is now fully enabled. In future, you will be prompted to enter the code from your authenticator app as part of the login process.



The screenshot displays the PortfolioHiWay login interface. On the left, a light gray sidebar contains a 'Sign In' section with the instruction 'Enter the verification code from your authenticator app.' Below this, a 'Verification Code' input field contains the text '295032'. A blue 'Verify' button is positioned at the bottom of the form. The main content area has a dark blue background with the PortfolioHiWay logo at the top left. The headline 'Your Partner on the Road to Alpha' is prominently displayed in white, followed by the tagline 'Helping you confidently reach your destination'. The background features abstract geometric shapes in white and light blue.



You will now be directed to the main login page, where you will enter your login credentials and verification code once more before seeing your client dashboard.

Sign In

Please enter your email and password.

Email Address

sophiawellington3080@gmail.com

Password

••••••••

Sign In

Forgot Password?

PortfolioHiWay

Your Partner on the Road to Alpha

Helping you confidently reach your destination

Dashboard

Performance

Accounts

Holdings

Transactions

Documents

Settings

Log Out

Portfolio Summary

Aggregate Market Value (CAD)

\$299,409.58

CAD Accounts

\$174,614.49

USD Accounts (in CAD)

\$124,795.09

in USD

\$90,875.78

Accounts 3

Sophia's CAD RRSP 2

CAD • RRSP

\$159,820.51

Sophia's CAD RRSP 1

CAD • RRSP

\$11,921.58

Sophia's USD RRSP

USD • RRSP

\$93,748.18

Advisor Insights

Tax Season

Sep 2, 2025

To view and download your applicable tax documents, click [here](#).

Client Resource

Aug 7, 2024

Navigate with confidence using our client resource modules. Tailored to anticipate your needs, these modules offer step-by-step guidance as you explore your portfolio's capabilities. From password preferences to leveraging advanced functions, our comprehensive resource modules are here to streamline your journey and enhance your experience.

Read more

Portfolio Composition

Account Type

Asset Class

Security Currency

Portfolio Performance

Contact

To ensure a timely response email us at:
support@portfoliohiway.com

T. +1 (833) 774 4929

E. support@portfoliohiway.com

W. portfoliohiway.com

Address

4005-3080 Yonge Street
Toronto, ON M4N 3N1

PRIVACY POLICY

At PortfolioHiWay Inc. we are committed to protecting the privacy of your personal information. We know how important your privacy is to you. We have adopted the following principles and guidelines that set out how we collect, use, and disclose personal information, and how we hold ourselves accountable and accessible to you.

For more information on our Privacy policy please visit: www.portfoliohiway.com/privacy-policy

© 2025 Portfolio HiWay Inc. All rights reserved.

Portfolio HiWay Inc. ("PortfolioHiWay") is an investment dealer and a member of the Canadian Investment Regulatory Organization (CIRO) and the Canadian Investor Protection Fund (CIPF).